

INFORMATION ONLY

RYECO
810 PICKENS INDUSTRIAL DRIVE
MARIETTA, GA 30067-3103
PHONE 770-423-9394

RYECO SYSTEM II OVERVIEW DRAWING

Drawing Number:
120SYSII0RYEC1

Drawing Name:
RYECO SYSTEM II OVERVIEW DRAWING

Drawn By:
T.W./SWB

Origin Date:
1/1/99

Revised By:
SWB

Revised Date:
4/8/2014

Drawing Number:

RYECO SYSTEM II OVERVIEW DRAWING

Drawn By:

Origin Date:

Revised By:

Revised Date:

© Copyright 2013, Ryeco Incorporated

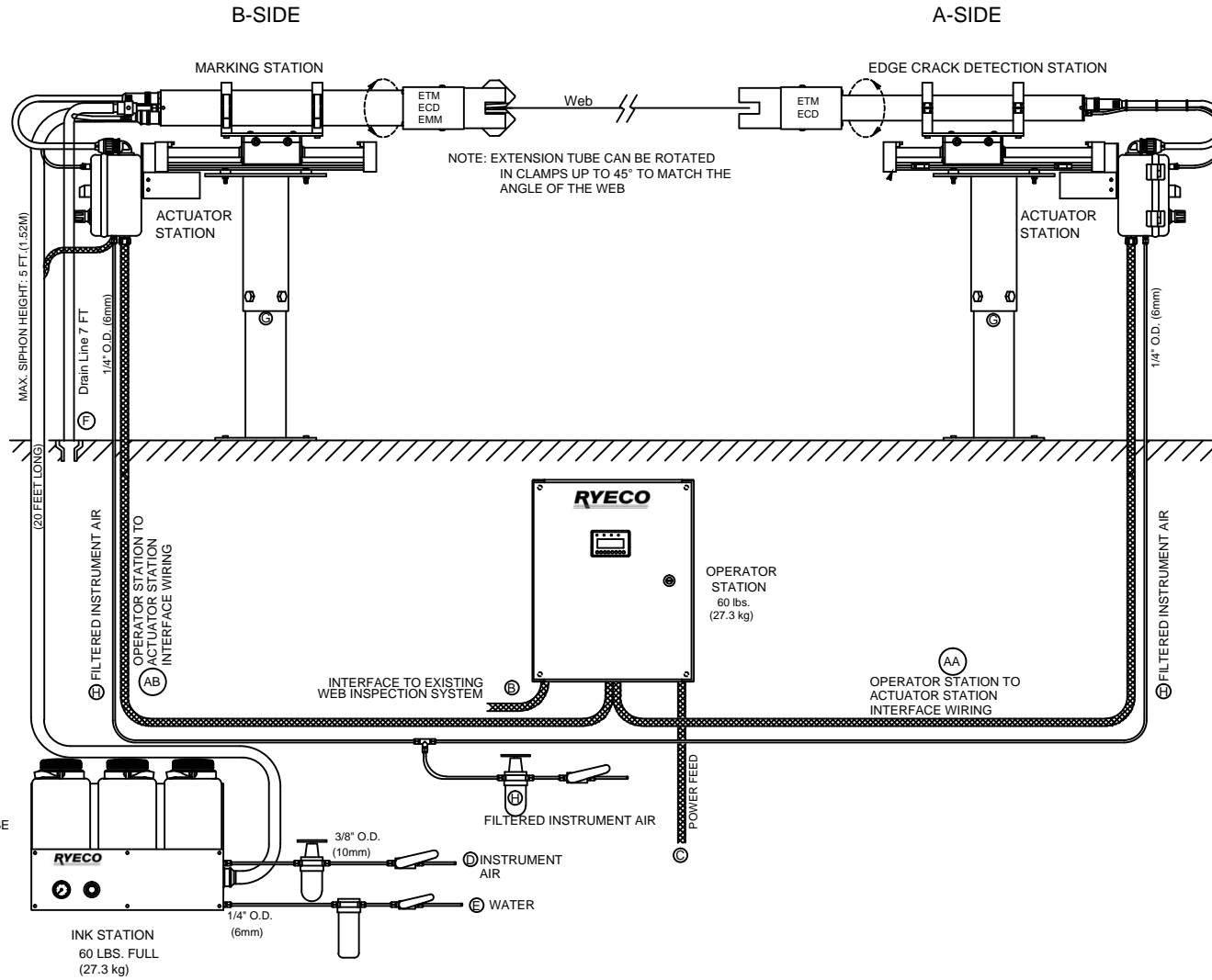

NOTE: BOTTOM OF INK TANKS CAN NOT BE MORE THAN 5FT BELOW THE WEB.

Mill Requirements - Cables

ITEM	SERVICE	DRAWING DESCRIPTION	CABLING
AA	OPERATOR STATION TO ACTUATOR STATION (A-SIDE)	OP-CB A-14	BELDEN 1476A OR EQUAL 8 PAIR 18 AWG SHIELDED
AB	OPERATOR STATION TO ACTUATOR STATION (B-SIDE)	OP-CB B-30	BELDEN 9777 OR EQUAL 15 PAIR 18 AWG SHIELDED
B	OPERATOR STATION TO WEB INSPECTION SYSTEM	OP-WIS-18	BELDEN 9775 OR EQUAL 9 PAIR 18 AWG SHIELDED
C	POWER TO OPERATOR STATION	110/220 VAC 6 AMP MAX. 110-OP-3	BELDEN 1036A OR EQUAL

Mill Requirements - Services

ITEM	SERVICE	DESCRIPTION	REQUIREMENT
D	INSTRUMENT AIR	INSTRUMENT AIR TO INK STATION	FILTERED 50 MICRON PRESSURE 60 TO 90 PSI [4-6 bar] FLOW 7 CFM (@60-90 PSI) WHEN MARKING
E	WATER	WATER TO INK STATION	FILTERED 50 MICRON PRESSURE 10 TO 50 PSI [.67-4.5 bar] FLOW 0.5 GPH [1.9 LPH]
F	DRAIN	DYE / FLUSH DISCHARGE DRAIN	VENTED DRAIN OPENING 94" I.D. MINIMUM
G	MOUNTING	MOUNTING POST	OPTIONAL
H	INSTRUMENT AIR	INSTRUMENT AIR ACTUATOR STATION	FLOW 2 CFM, 35 PSI [2.4 bar]